

# MATÉRIEL D'ASSEMBLAGE • CONNECTING MATERIALS •

# 4

*Fastening up the World*



## 40 RIVETS ÉTIRÉS • DRAWN RIVETS

Art.	d(d <sub>1</sub> ) / V / D (mm)	Matériau / Material ▶ acier / steel
AVEC REVÊTEMENT • WITH COATING		
40A0360060	3,6/6,0/7,0	<p>▶</p> <p>TRAITEMENT DE SURFACE STANDARD nickel, nickel noir, zinc</p> <p>CONDITIONNEMENT STANDARD en vrac: 5000 pcs, 15000 pcs</p>
40A0390074	3,0(3,9)/7,4/6,0	<p>▶</p> <p>STANDARD SURFACE FINISH nickel, black nickel, zinc</p> <p>STANDARD PACKING loose: 5000 pcs, 15000 pcs</p>
40A0380050	3,8/5,0/6,0	
40A0380060	3,8/6,0/6,0	

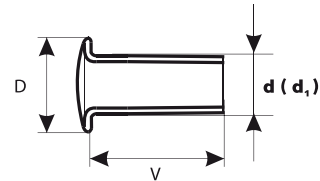

## 41 RIVETS ÉTIRÉS • DRAWN RIVETS

Art.	d / V / D (mm)	Matériau / Material ▶ acier / steel
EN DEUX PIÈCES • DOUBLE		
4110540170	5,4/6,0/10,6 5,8/11,0/10,5	<p>▶</p> <p>TRAITEMENT DE SURFACE STANDARD nickel</p> <p>CONDITIONNEMENT STANDARD en vrac: 1000 pcs, 5000 pcs</p>
4120360110	3,6/4,5/7,0 3,4/6,7/7,0	<p>▶</p> <p>STANDARD SURFACE FINISH nickel</p> <p>STANDARD PACKING loose: 1000 pcs, 5000 pcs</p>
4120360130	3,6/4,5/7,0 3,2/8,0/7,0	

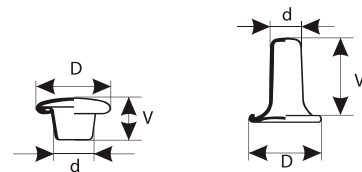

pièce de dessous • lower part

## 42 RIVETS ROULÉS • COILED RIVETS

Art.	d / V / D (mm)	Matériau / Material ▶ acier / steel
4210600100	6,0/10,0/8,0	<p>▶</p> <p>TRAITEMENT DE SURFACE STANDARD nickel</p> <p>CONDITIONNEMENT STANDARD en vrac: 5000 pcs</p>

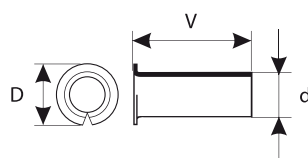

▶

STANDARD SURFACE FINISH  
nickel

STANDARD PACKING  
loose: 5000 pcs



# MATÉRIEL D'ASSEMBLAGE • 4 CONNECTING MATERIALS •

