

Fastening up the World

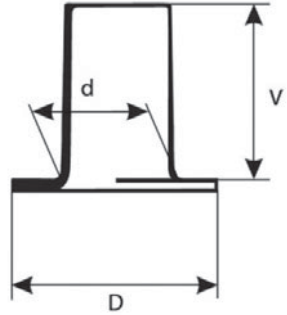

40 RIVETS ÉTIRÉS • DRAWN RIVETS

Art.	d / V / D (mm)	Matériau / Material ▶ acier / steel
FEMELLE • OPEN		
4010320062 - 060	3,2/6,2/6,0	<p>▶</p> <p>TRAITEMENT DE SURFACE STANDARD nickel, nickel noir, zinc</p> <hr/> <p>CONDITIONNEMENT STANDARD en vrac: 5000 pcs, 15000 pcs</p> <hr/> <p>▶</p> <p>STANDARD SURFACE FINISH nickel, black nickel, zinc</p> <hr/> <p>STANDARD PACKING loose: 5000 pcs, 15000 pcs</p> <hr/> 
4010300050 - 050	3,0/5,0/5,0	
4010310068 - 073	3,1/6,8/7,3	
4010370064 - 063	3,7/6,4/6,3	
4010360076 - 060	3,6/7,6/6,0	
4010390053 - 054	3,9/5,3/5,4	
4010390063 - 054	3,9/6,3/5,4	
4010400030 - 060	4,0/3,0/6,0	
401039A047 - 060	3,9/4,7/6,0	
4010400050 - 070	4,0/5,0/7,0	
4010400060 - 060	4,0/6,0/6,0	
4010400060 - 070	4,0/6,0/7,0	
4010500044 - 072	5,0/4,4/7,2	
4010520052 - 100	5,2/5,2/10,0	
4020440061 - 080	4,4/6,1/8,0	

Matériau / Material ▶ **laiton / brass**

Art.	d / V / D (mm)	Matériau / Material ▶ acier / steel
MALE • CLOSED		
4040320087 - 070	3,2/8,7/7,0	
4040340067 - 070	3,4/6,7/7,0	
4040340087 - 084	3,4/8,7/8,4	
4040350067 - 070	3,5/6,7/7,0	
4040340071 - 084	3,4/7,1/8,4	



MATÉRIEL D'ASSEMBLAGE • 4 CONNECTING MATERIALS •



MATÉRIEL D'ASSEMBLAGE • CONNECTING MATERIALS •

4

Fastening up the World



40 RIVETS ÉTIRÉS • DRAWN RIVETS

Art.	d(d ₁) / V / D (mm)	Matériau / Material ▶ acier / steel
AVEC REVÊTEMENT • WITH COATING		
40A0360060	3,6/6,0/7,0	▶ TRAITEMENT DE SURFACE STANDARD nickel, nickel noir, zinc CONDITIONNEMENT STANDARD en vrac: 5000 pcs, 15000 pcs
40A0390074	3,0(3,9)/7,4/6,0	▶ STANDARD SURFACE FINISH nickel, black nickel, zinc STANDARD PACKING loose: 5000 pcs, 15000 pcs
40A0380050	3,8/5,0/6,0	
40A0380060	3,8/6,0/6,0	

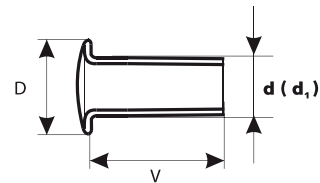

41 RIVETS ÉTIRÉS • DRAWN RIVETS

Art.	d / V / D (mm)	Matériau / Material ▶ acier / steel
EN DEUX PIÈCES • DOUBLE		
4110540170	5,4/6,0/10,6 5,8/11,0/10,5	▶ TRAITEMENT DE SURFACE STANDARD nickel CONDITIONNEMENT STANDARD en vrac: 1000 pcs, 5000 pcs
4120360110	3,6/4,5/7,0 3,4/6,7/7,0	▶ STANDARD SURFACE FINISH nickel STANDARD PACKING loose: 1000 pcs, 5000 pcs
4120360130	3,6/4,5/7,0 3,2/8,0/7,0	

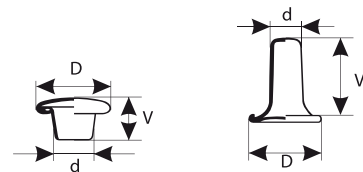

pièce de dessous • lower part

42 RIVETS ROULÉS • COILED RIVETS

Art.	d / V / D (mm)	Matériau / Material ▶ acier / steel
4210600100	6,0/10,0/8,0	▶ TRAITEMENT DE SURFACE STANDARD nickel CONDITIONNEMENT STANDARD en vrac: 5000 pcs

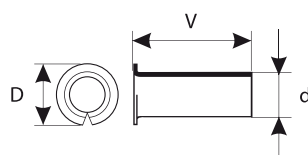

▶
 STANDARD SURFACE FINISH
 nickel
 STANDARD PACKING
 loose: 5000 pcs



MATÉRIEL D'ASSEMBLAGE • 4 CONNECTING MATERIALS •

